

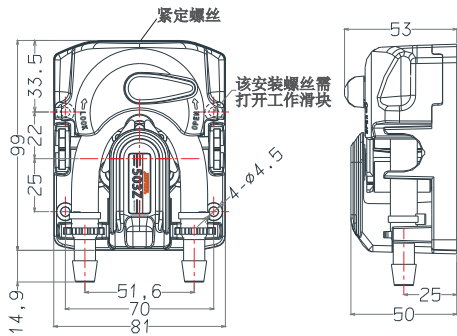

1. Dimension

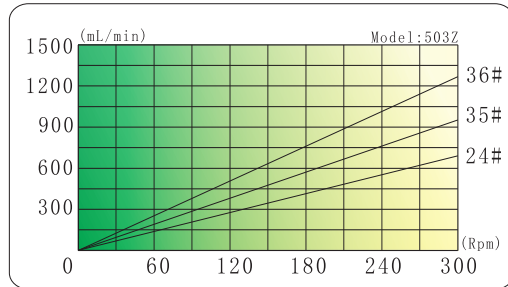

2. Flow rate



Model #	Tube	Tube clamp	Housing	Roller	Max flow	Power	Weight
503Z/WTT	24#	Fixed	PA66	POM	1190mL/min	24W	598g
503Z/ZLX	35#				1240ml/min		594g
503Z/ZL	36#				1280mL/min		710g
503Z/BT					1270mL/min		896g

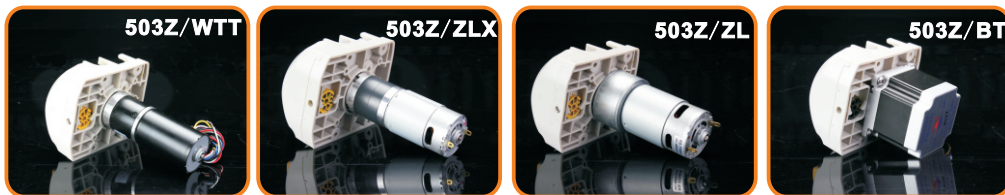

3. Install and use

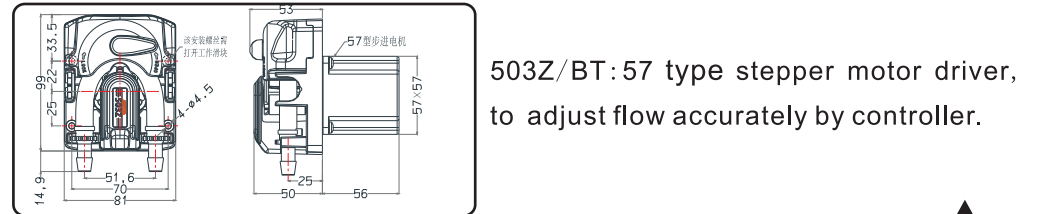
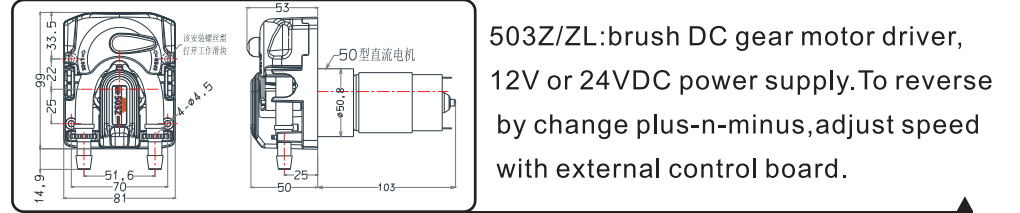
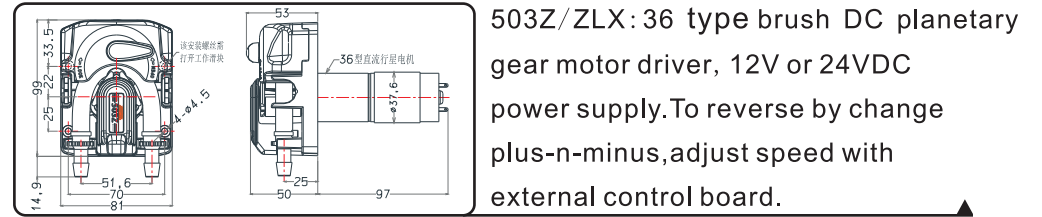
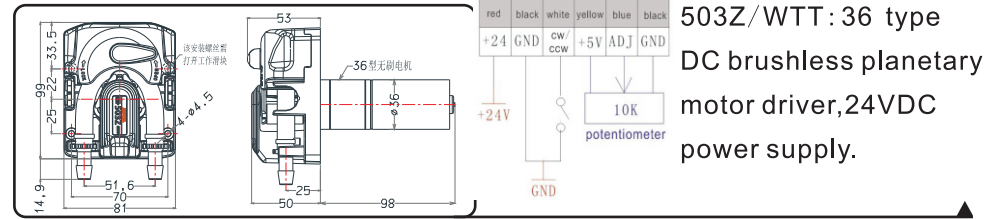

4. Assemble tube

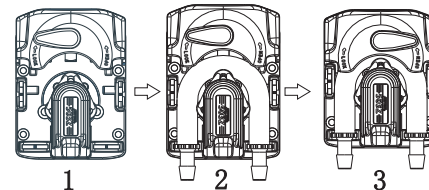

1. Rotate the handle counterclockwise to open the slider.

2. The tube is bypassed by the roller, and the joints at both ends are snapped into the slot (the zip tie connector is facing upwards and the tube is not twisted).

3. Rotate the handle clockwise to the rightmost to lock slider.

Note: If you find the tube cracks, please clean the inside pump head.

please regularly apply grease to extend tube and pump head life. Tube length inside pump head: 132mm.

When the pump head can not suck up liquid or the outlet pressure needs to be increased, the set screw above the pump head can be adjusted clockwise (the adjustment limit is that the pump head can be opened and closed normally, which will affect the service life of the tube).

