

603K Operation Manual

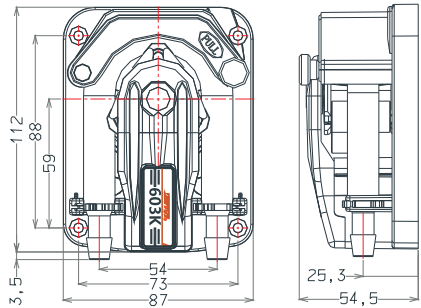

1. Dimension



2. Flow rate

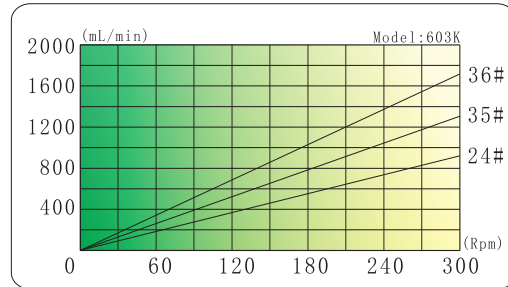

Model #	Tube	Tube clip	Housing	Roller	Max flow	Power	Weight
603K/WTT	24#	Fixed	PA66	POM	1550mL/min	24W	622g
603K/ZLX	35#				1710mL/min		
603K/ZL	36#				1920mL/min	32W	750g
603K/BT					1650mL/min		



3. Install and use

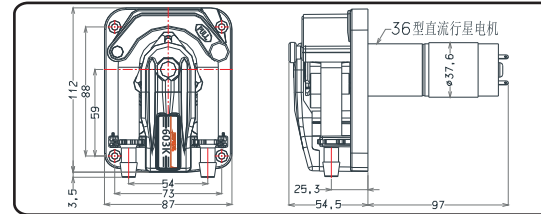
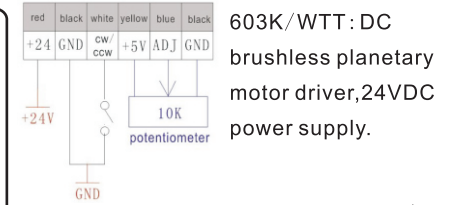
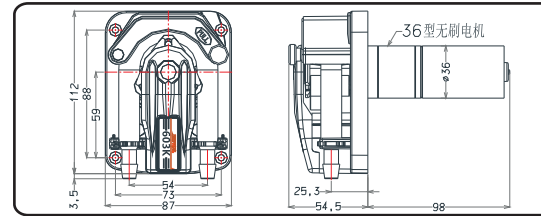

603K/ZLX: brush DC planetary gear motor driver, 12V or 24VDC power supply. To reverse by change plus-n-minus, adjust speed with external control board.

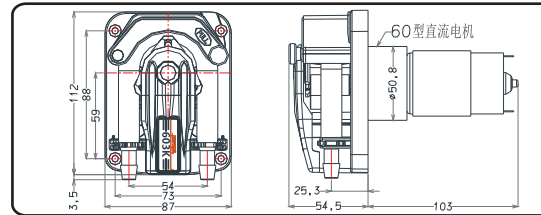

603K/ZL: brush DC gear motor driver, 12V or 24VDC power supply. To reverse by change plus-n-minus, adjust speed with external control board.

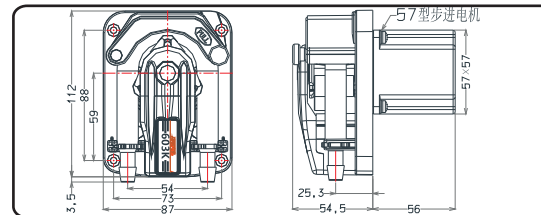

603K/BT: stepper motor driver, to adjust flow accurately by controller.

4. Assemble tube

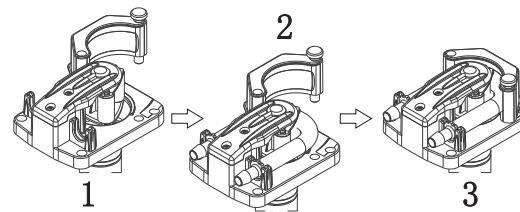

1. Raise the screw and turn the block clockwise.
 2. Put the built-in tube around the roller, and press down the fittings at the two ends in the slots. (zip ties up, the tube no distortion).
 3. Raise the screws and turn the block counter-clockwise to let the location pin into position.
- Note: If you find the tube cracks, please clean the inside pump head. Regularly apply grease to extend tube and pump head life.

