

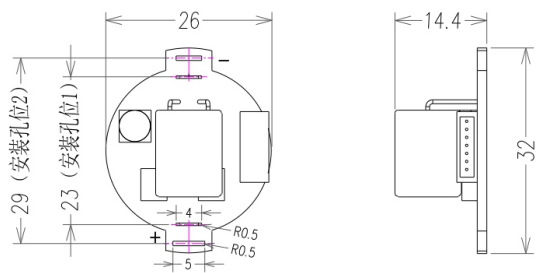

**Features**

- Compact structure, small size, full functionality
- Provides start/stop, speed adjustment, direction control, and soft start functions
- Supports both built-in potentiometer speed control and external potentiometer speed control
- Over-temperature protection function to stop the motor when the chip overheats due to excessive current, and restarts when the chip temperature decreases

**Pump Size**



**Technical Specifications**

Power Supply	DC 12-24V
Power	≤26W(working current<1.1A)
Work Environment	Temperature range: 0°C (no freezing) to 60°C, relative humidity <85%RH
Net Weight	6.6g
Functions	Soft start, over-temperature protection, start/stop, direction control (external control wiring), speed adjustment (combined with built-in and external potentiometer)
Motor Type	Type 28 ZL, Type 28 ZLX, 395 motor (293KC special), type 32 ZLX (MN3 special), type 36 ZLX, type 37 ZL (MN3 special), type 36 ZLX, type 37 ZL (MN3 special), TT-555 square motor, type RG50-555 ZL

